



# SMART 6D TOOTHBRUSH



INSTRUCTION  
MANUAL

# INSTRUCTION MANUAL

babahu  
SMART 6D  
TOOTHBRUSH

---

Before using this product, please  
read the instruction manual carefully.  
Save the manual for future reference.

---

# CONTENTS

1	Notes and precautions	02
2	Parts and configuration	08
3	Quick start guide	10
4	Cleaning the brush head	12
5	Recharging the handpiece	13
6	Storing the toothbrush	15
7	Environmental precautions	16
8	Product features	18
9	Warranty and service	22

## NOTES

### DANGER

The charging station should be kept dry and far from water (including bathtubs or water basins). You must not dip the wireless charging station into water or other liquids. After cleaning, make sure the charging station is completely dry before connecting to a power source.

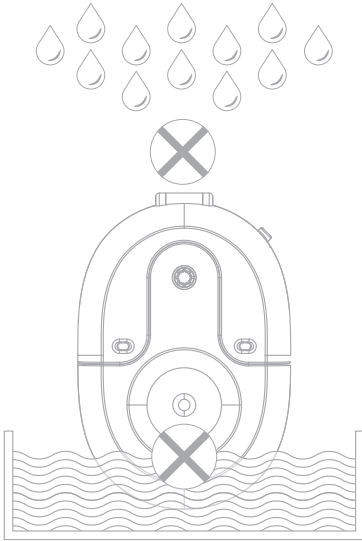

## NOTES

### WARNING

Before connecting the product to a power source or outlet, please check if the product voltage is consistent with the power being supplied by the source or outlet.

If any damage occurred to the wireless charging station, don't use it any more. If the damage occurred to the cable or plug of the charging station, please be sure to replace with original accessories to avoid danger.

If any faults arise in the product (U-shape brush head, handpiece), please stop using it. No parts can be fixed by users themselves. If the product is damaged, please contact the customer service center.

Don't use the wireless charging station outdoors or near heated surfaces.

This device should not be used unsupervised by:

(1) children, or (2) people who are physically or mentally handicapped or lack experience with or knowledge of the device, unless they can get supervision and instruction for the proper use of the device. Children should always be supervised.

## NOTES

### CAUTION

- Do not use this product in the bath or shower.
- If you have had oral or gum surgery in the past two months, consult your dentist before using this product.
- The U-shape brush head of the product is composed of medical grade silica gel. If any discomfort is caused by using it, please consult with your dentist and buy the hospital Pro version.
- The BBH-x1 series smart 6D toothbrush meets the safety standard of electromagnetic equipment. For any questions about a pacemaker or other implant, consult a doctor or manufacturer of the implant before using the brush.
- The product is only used for cleaning teeth and gums. Do not use it for any other purpose. If you feel any discomfort or pain, stop using it and contact your doctor.
- If you have medical problems, please consult your doctor before using the smart 6D toothbrush, or use the hospital Pro version.
- The BBH-x1 series smart 6D toothbrush is a personal product and cannot be used by dentists in clinics or institutions for multiple patients.
- Please stop using the U-shape brush head when it is heavily deformed or its bristles badly bent. It is recommended to replace the U-shape brush head every 6-12 months. If there are signs of wear, it should be replaced sooner.
- The U-shape brush head is resistant to high temperatures and can be cleaned in a dishwasher.

- Do not use other brush heads not recommended by the manufacturer.
- Children should be guided when they brush their teeth until they develop good brushing habits.
- The use of foam toothpaste is recommended, as it rapidly spreads to all corners of the mouth and the friction-free qualities are more gentle and suitable for children.

## NOTES

### CERTIFICATION INSTRUCTIONS

#### Electromagnetic Field (EMF)

Babahu products comply with all relevant standards on electromagnetic fields (EMF).

#### Electrical certification

**CE FC TELEC**

#### Food contact level testing

**FDA** GB4706.59 

#### Environmental certification

**RoHS REACH PAHs**



#### Waterproof Grade IPX7 immersion type

Soak for 30 minutes in water up to 1 meter deep

## NOTES

### FCC STATEMENT

This equipment has been tested and found to comply with the limits for a WPC device, pursuant to Part 18 of the FCC Rules. These limits are designed to provide reasonable protection against harmful interference in a residential installation.

#### Notes

This equipment has been tested and found to comply with the limits for a wireless power charger, pursuant to Part 18 of the FCC Rules. These limits are designed to provide reasonable protection against harmful interference in a residential installation. This equipment generates, uses and can radiate radio frequency energy and, if not installed and used in accordance with the instructions, may cause harmful interference to radio communications. However, there is no guarantee that interference will not occur in a particular installation. If this equipment does cause harmful interference to radio or television reception, which can be determined by turning the equipment off and on, the user is encouraged to try to correct the interference by one or more of the following measures:

- Reorient or relocate the receiving antenna.
- Increase the separation between the equipment and receiver.
- Connect the equipment into an outlet on a circuit different from that to which the receiver is connected.
- Consult the dealer or an experienced radio/TV technician for help.

#### Caution

Changes or modifications not expressly approved by the party responsible for compliance could void the user's authority to operate the product.

This equipment complies with FCC radiation exposure limits set forth for an uncontrolled environment. This equipment should be installed and operated with minimum distance 20cm between the radiator and your body. This transmitter must not be co-located or operating in conjunction with any other antenna or transmitter.

## NOTES

### FREQUENCY BANDS AND POWER

Operation Frequency: 134.9–174.4kHz

H-field Strength: -8.65dB n A/m @10m distance

## PARTS AND CONFIGURATION

1

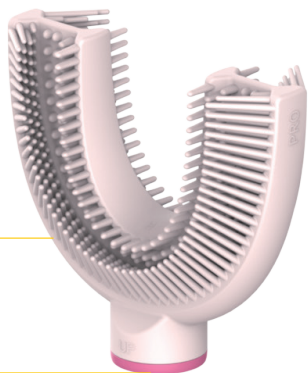

- 1 6D U-shape medical grade silicone brush head
- 2 Handpiece
- 3 Wireless charging station

Smart color ring

Connector for the brush head

2

Start Button

Clean  
daily cleaning indicator

Gum Care  
gum cleaning indicator

Charging indicator

3

Holder for brush head

USB plug

## QUICK START GUIDE

1

Rotate the U-shape brush head into the connector on the handpiece. Apply the foam toothpaste to the grooves on either side of the U-shape brush head.

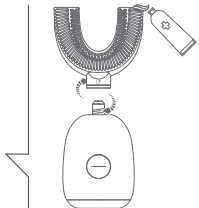

2

With your teeth slightly interlocked in the U-shaped groove, gently move your teeth (or brush head) to make the U-shape brush head fit better. The start button should be pointing upward towards the upper jaw.

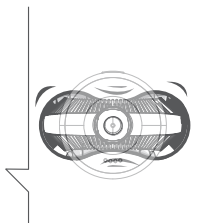

3

Press the start the button. The U-shape brush head will begin to clean the teeth comprehensively. The soft, long conical bristles will perform a deep clean.

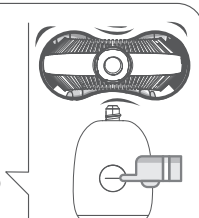

---

In order to maximize the effectiveness of the smart 6D toothbrush, complete cleaning of all parts of the mouth can be finished in 10 seconds (the app allows you to adjust cleaning time between 10–60 seconds). By intelligently identifying different selected brush heads, the smart 6D toothbrush can achieve full cleaning and also massage gums with different comfort levels through intelligent sensing (there are 13 different adaptive brush head schemes built into the handpiece).

---



## RECHARGING THE HANDPIECE

### The smart 6D toothbrush has 2 modes:

- Clean / Daily cleaning mode (standard mode)
- Gum Care / Gum care and cleaning mode (gentle massaging of the gums)
- Before starting, long pressing the start button for 1 second will switch the mode of the toothbrush. The default is daily cleaning mode.

### The smart 6D toothbrush strength control:

- 10 levels of adjustable strength (via bluetooth app)
- 3 adjustable strengths (through start button)
- The default strength is 3(S) / 7(M) / 10(L) and the duration is 20 seconds

Bluetooth app is available for the BBH-X1 Plus edition and BBH-X1 Pro edition.

App controls functions that let you customize your comfort.

## CLEANING THE BRUSH HEAD

Clean the U-shape brush head regularly.

Rinse the U-shape brush head thoroughly after brushing your teeth.

Dry the brush head and make sure to also remove the water from within the grooves.

If necessary, wash the surface with neutral soap and scrub with a soft cloth.

Do not use sharp objects to clean.

1

Place the handpiece on the charging station.

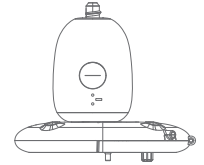

2

Connect the USB plug to a power source and recharging will start.

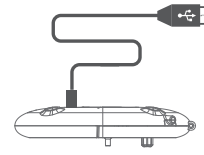

3

While recharging, a red light will flash slowly.

When recharging is complete, the light becomes bright green and then will go out.

When the battery is fully charged, the indicator light will go out.

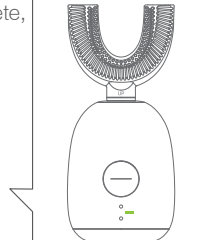

4

Do a complete charge before the first use.



5

When the battery is running low on power, a red light will flash quickly.

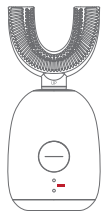

6

**Notes:**

1. Don't place metal objects in the groove of the charging station. Doing so may affect the charging process and cause the charging station to overheat (although the charging station is designed to detect any foreign metal objects and prevent overheating).
2. Only one brush can be recharged on the charging station at one time.

## STORING THE TOOTHBRUSH

If you don't use the smart 6D toothbrush for a long time, please disconnect the power supply from the charging stand. Clean all parts and store them in a cool and dry place away from direct sunlight. Charge the handpiece once every 3 months to condition the batteries.

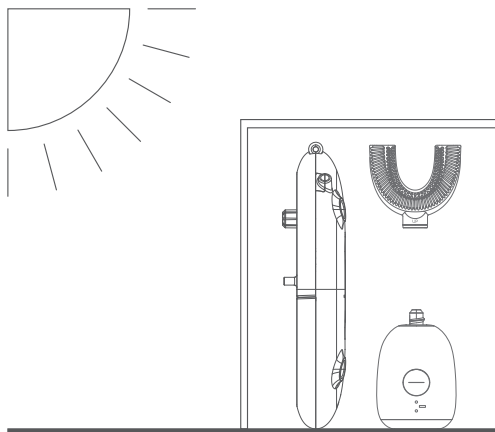

## ENVIRONMENTAL PRECAUTIONS

Do not throw away this product with normal household waste, but bring it to an official collection point for recycling. Dispose of the rechargeable battery at an official collection point for batteries. By doing this, you help to protect the environment.

**Only remove the rechargeable battery at the end of the product's life. This process is not reversible!** Make sure the rechargeable battery is discharged. Observe basic safety precautions. To remove the rechargeable battery from the handpiece: Place the handpiece on a solid surface and remove the connector of the brush head, then lightly tap the housing about 2.5cm from the bottom edge with a hammer. Remove the main body with a screwdriver, open the battery pad and crush the bottom of the main body to remove battery.

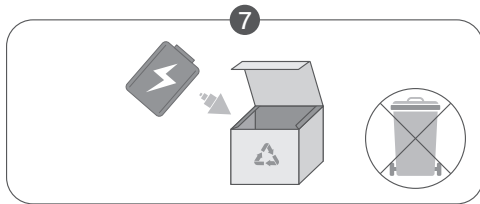
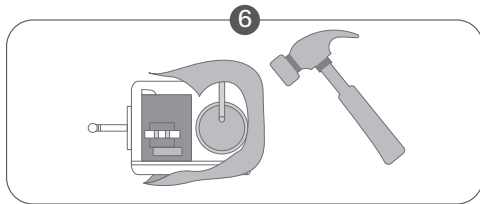
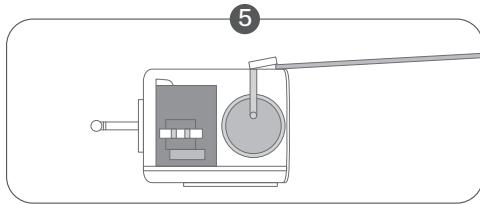
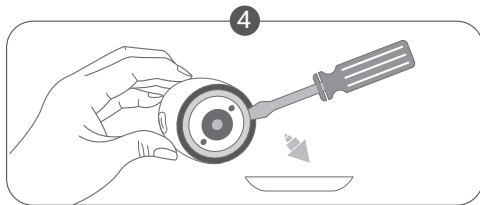
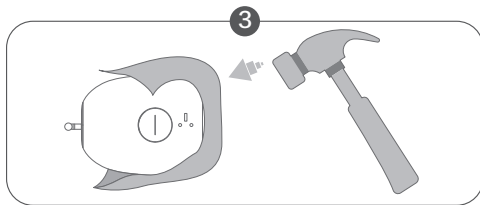
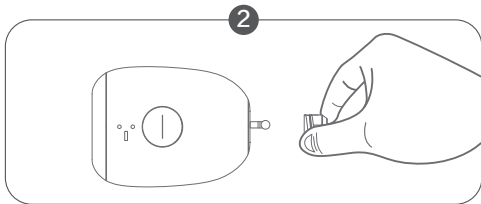
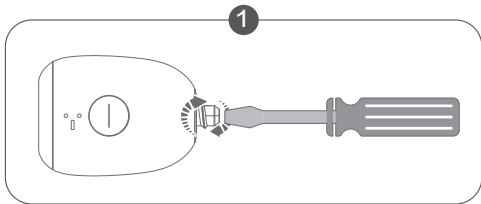

## PRODUCT FEATURES

### Children's Version

1. Patented 6D U-shape brush head and super soft conical bristles can minimize the pressure to the gums when brushing teeth. Low-frequency design can gently care for the child's young teeth and gums, so children can use it safely.
2. Children will be brushing their teeth using a scientifically proven technique. They will love to brush their teeth because the ultra-strong antimicrobial child-specific medical grade silicone material is comfortable, and the brush uses the bass brushing technique.
3. Children can enjoy 20 seconds of all-around cleaning of their teeth, efficiently cleaning plaque and fighting against tooth decay enabled by the ultra-fine silica gel cone hair and sonic power.
4. It is easy to brush and protect their teeth with the convenient functions of hands-free operation, a unique large button and one touch open.
5. Unique design with drop resistance can avoid damage to the product.
6. Unique intelligent color ring design makes easy recognition of the U-shape brush head, which allows for children to quickly find and use their brush head.

Phonetic description	
ENGLISH	CHINESE
Great	你很棒
Keep it up	加油
Please bite gently	请轻轻咬合
Time to charge	请充电
Babahu welcome	巴巴虎欢迎你
See you next time	小朋友记得下次刷牙



## PRODUCT FEATURES

### Adult's Version

1. Gingival plaque and bacteria can be easily removed using minimal stimulation to the gums. The high-efficiency motor, patented 6D U-shape brush head, as well as super soft conical bristles create a superior teeth cleaning experience.
2. The product features an exclusive deep cleaning mode, careful gum massage and gum bleeding prevention.
3. The 6D U-shape brush head is composed of medical grade silicone material.
4. The product features a cool base design, flexible placement of multiple brush heads, and a U-shape brush head with a unique color ring at the bottom.
5. Automatic comfort sensing through artificial intelligence tracks your usage habits and creates exclusive comfort.
6. Ultra-long standby, a full charge will last for 30 days, so you can travel without worry.
7. Smart app can customize your exclusive comfort.
8. The upgraded version has a wireless charging station that can also provide wireless charging for Qi standard mobile phones and smart devices (please refer to the specific instructions of other Qi devices).
9. Optional intensive care brush heads are available.
10. The customized brush head service provides a one-time 3D oral scan and lifelong oral service.



## WARRANTY AND SERVICE

### Warranty

The following items are not included in the International warranty terms:

The U-shape brush head.

Damage caused by misuse, abuse, neglect, modification or unauthorized repair.

Normal wear and tear, including rips, scratches, wear, discoloration or color fading.

-----  
If you need more information or service, or have any questions, please visit the official website :

[www.babahutoothbrush.com](http://www.babahutoothbrush.com)

You also can contact the babahu customer service center in your area.

If you can not find a customer service center in your area, please contact your local babahu dealer.

-----

-----  
**Bairui Oral Care (Zhuhai) Co., Ltd.**

Address: #2-513 Nanhai e-cool, #1 Xinghua Road,  
Nanshan District, Shenzhen, GD, China.

Service Phone : 400 888 1260

(E-mail): [babahu@babahu8.com](mailto:babahu@babahu8.com)

Website: [www.babahutoothbrush.com](http://www.babahutoothbrush.com)  
-----